

Type 1000 Stainless Steel Ball Valves

Regular port, 3-pce body design, Threaded or socket welding ends

Page 10 for Pressure-Temperature Ratings

Features

- Blowout-proof stem
- Swing-away body for maintenance ease
- Choice of threaded ends:
 - Rc threads to BS 21 (Fig. U3TZM)
 - NPT threads to ASME B1.20.1 (Fig. AKU3TZM)
 - Socket welding ends to BS 5351 (Fig. SWU3TZM)
 - Socket welding ends to ASME B16.11 (Fig. AWU3TZM)

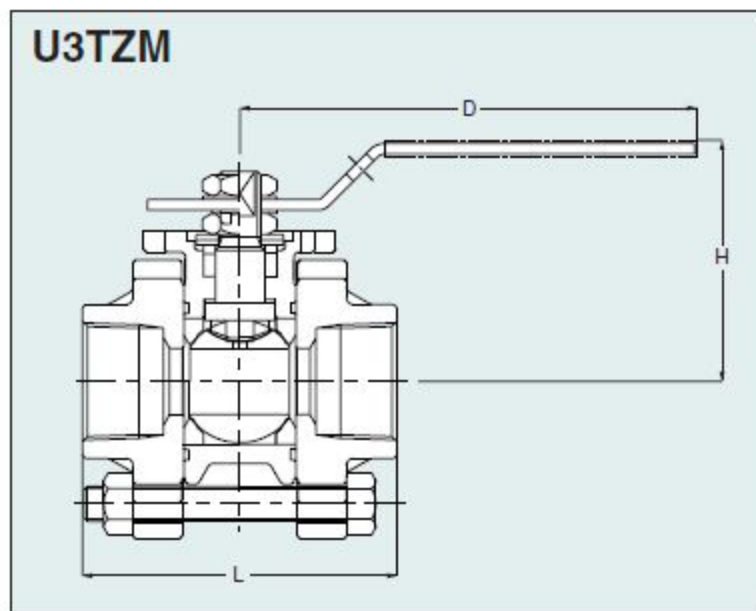

Standard materials

Parts	Materials
Body	CF8M
Body cap	CF8M
Ball	316 or CF8M
Stem	316
Seat	HYPATITE® PTFE
Gland packing	PTFE
Gasket	PTFE
Handle	Plastic covered S.S.

End-to-end dimensions: KITZ standard

Dimensions

Unit: mm

Valve Size	in.	1/2	3/4	1	1 1/4	1 1/2	2
	mm	15	20	25	32	40	50
Ball Bore		10	14	19	24	30	38
L		63	71	90	103	110	127
H		48	60	69	83	88	104
D		120	130	130	150	150	180

Valve operator

Lever operation
Oval handle as option

Note

• Use U3TZFM for sizes 1/4" & 3/8".